

Please read instructions before commencing installation and retain for future reference.

## SPECIFICATIONS

- **Material:** Metal + Aluminium
- **Lamp type:** 1 x E14 , MAX 40W
- **Ingress Protection:** IP20. Protection against entry of solid objects greater than 12mm in diameter.

## INSTALLATION INSTRUCTIONS

 Electrical products can cause death, injury, or damage to property. Maintenance and installation should only be carried out by a professional electrician.

- Install the E14 lamp in lampholder (1).
- Then connect the plug in to socket (2).
- Switch on the light.

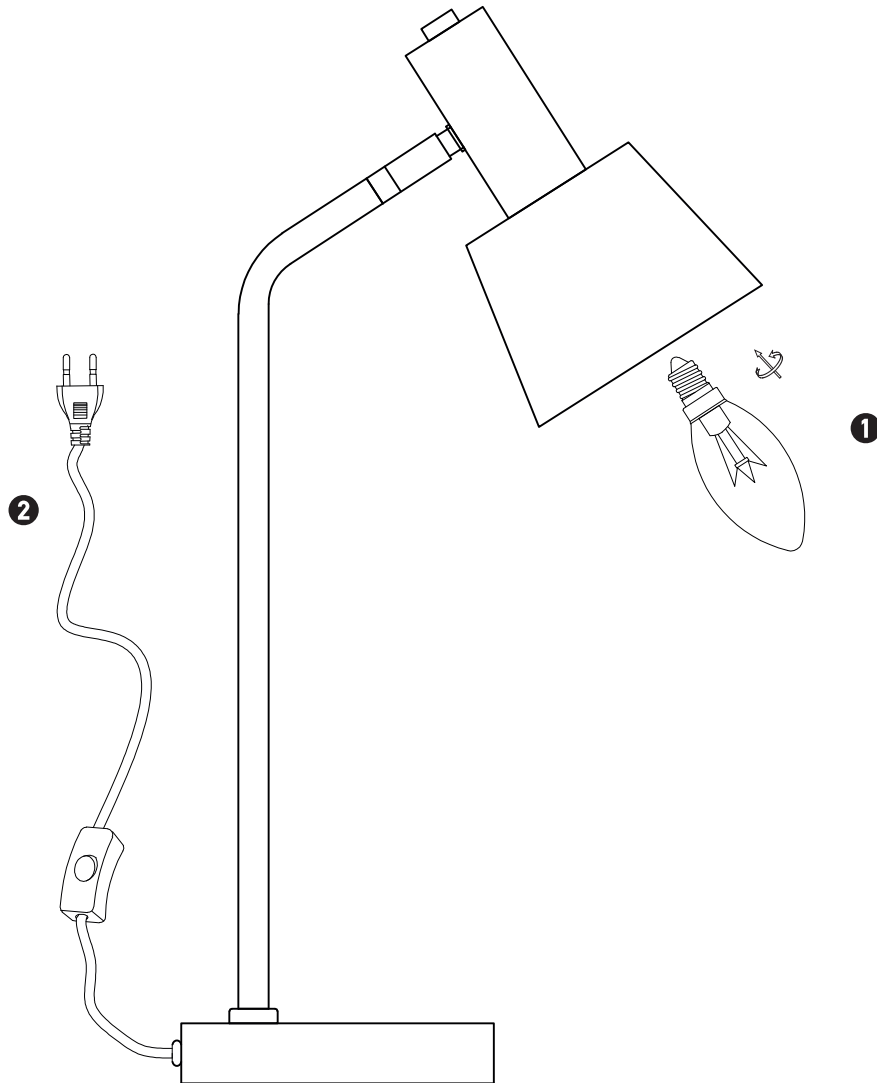

## WARNING

- Make sure that the products is installed properly before connecting to electricity.
- Do not cover the fitting.
- Not for outdoor use or in wet conditions.

